

# CROSS

Cultivator for simplified tillage



CROSS S 3 DRIVE (harrow B)

## STANDARD EQUIPMENT

- » suspension axle  $\varnothing 70-825/\varnothing 36$  mm
- » 3 rows of CX tines with pad-welded chisels with 370 mm undercutters and spring protection
- » external CX tines with raking mouldboards
- »  $\varnothing 460$  mm disc harrow (type A) with rubber triangular shock-absorbers, bolt adjustment of working depth and replaceable, maintenance-free hub
- » pipe roller  $\varnothing 600$  mm
- » hydraulic adjustment of working depth on the roller
- » rigid frame

### CROSS:

- » CX tine working depth:
- » with undercutter: 15 cm
- » without undercutter: 30 cm
- » load per tine: 550 kg
- » tines spacing: 30 cm

## MODEL

3

3,5

4

## CROSS S

### ACCESSORIES AT EXTRA CHARGE

surcharge for a set of tines with narrow coulters

DRIVE 670 System with 2 000 mm long drawbar

DRIVE 800 System with 2 000 mm long drawbar

surcharge for drawbar w. multi-point length adjustment 2,5–3,0–3,5 m (only Cross DRIVE) \*

surcharge for hitch,  $\varnothing 40$  mm (only Cross DRIVE w. adjustable drawbar length) \*

surcharge for hitch,  $\varnothing 50$  mm (only Cross DRIVE w. adjustable drawbar length) \*

surcharge for furrow type B (only Cross DRIVE)

hydraulic adjustment of furrow type B (only Cross DRIVE)

set of front support wheels (only Cross Drive)

set of scrapers DRIVE system

surcharge for 12-tine version

surcharge for 15-tine version

warning plates kit

warning plates kit with lamps

possibility of mounting the seeder ETA

rollers acc. to table ROLLER LIST (page 45–47)



CROSS S mounted with pipe roller and harrow A



DRIVE system + harrow B



Tine CX

CROSS S	3	3,5	4	DRIVE 3	DRIVE 3,5	DRIVE 4
Weight with $\varnothing 600$ mm pipe roller [kg]	2 260	2 460	2 620	2 760	3 080	3 240
Power demand [HP]	150 ÷ 180	160 ÷ 190	170 ÷ 200	140 ÷ 170	150 ÷ 180	170 ÷ 200
No. of tines [pc.]	10	12	13	10	12	13
Tines spacing in the machine [mm]	300	290	300	300	290	300
Underbeam clearance [cm]	850	850	850	850	850	850
Beams spacing [cm]	750	750	750	750	750	750
Length of the machine [cm]	397	397	397	430	430	430

# CROSS HP

Cultivator for simplified tillage



CROSS HP 6

## STANDARD EQUIPMENT

- » semi-mounted axle 965/ø336mm
- » 4 rows of CX tines with spring protection and undercut width 370mm
- » external CX tines with raking mouldboards
- » ø460mm disc harrow (type A) with triangular rubber shock-absorber and bolt adjustment of working depth, replaceable, maintenance-free hub
- » ø600mm pipe roller
- » hydraulic adjustment of working depth
- » frame hydraulically folded for transport with the help of 4 cylinders
- » chassis with wheels 500/45-22,5 and drawbar 2800 mm
- » front support wheels (340/55-16)

## MODEL

4

5

6

## CROSS HP

## ACCESSORIES AT EXTRA CHARGE

surcharge for a set of tines with narrow coulter

surcharge for air brakes

surcharge for hydraulic brakes

hydraulic adjustment of the front wheels

—

surcharge for hitch, ø40mm \*

surcharge for hitch, ø50mm \*

warning plates kit

warning plates kit with lamps

rollers acc. to table ROLLER LIST (page 45–47)



Harrow A

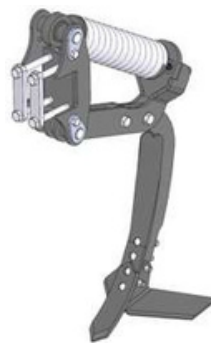

Tine CX



Tine with narrow coulter

CROSS HP	4	5	6
Weight with ø600mm pipe roller [kg]	6 300	6 950	7 270
Power demand [HP]	180 ÷ 240	240 ÷ 280	280 ÷ 320
No. of tines [pc.]	13	17	19
Tines spacing in the machine [mm]	300	290	305
Underbeam clearance [cm]	850	850	850
Beam spacing [cm]	750	750	750
Length of the machine [cm]	760	760	760

## CROSS HP:

- » CX tine working depth: with undercutter: 15 cm without undercutter: 30cm
- » load per tine: 550 kg
- » tines spacing: 30cm